

### New Top-Hook Fascia

As part of our commitment to continuously improving our products, we are changing certain fascias to a version that hooks to the bracket from the top edge first—rather than from the bottom. This new configuration greatly simplifies installation and improves safety.

Orders placed after Sept. 1 will receive the new fascia. For more information on the Top-Hook Fascia, please contact Customer Service at +1 (718) 729-2020, option 3.

#### Fascia installation steps

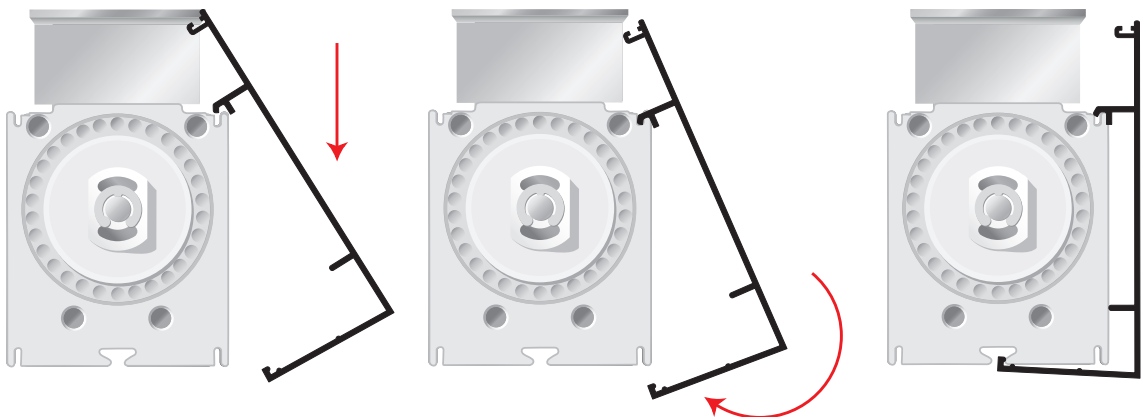

Mecho®/5 Extended Bracket

Labelling on the fascia will clearly differentiate the new improved version from the previous one.

#### Previous fascia label



#### Current fascia label

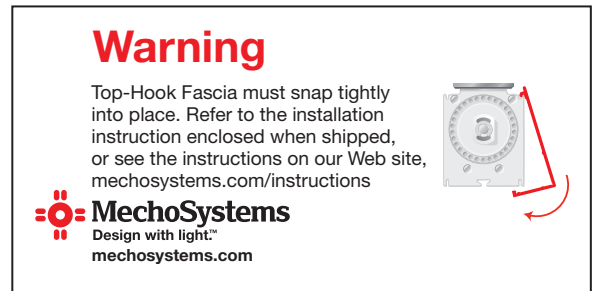

#### Brackets using the new Top-Hook Fascia include:

- Mecho®/5 Wide Bracket
- No. 10 Mecho®/5 DoubleShade® Bracket
- No. 20 Electro®/3 DoubleShade® Bracket
- Mecho®/5 Extended Bracket
- Electro®/3 Extended Bracket
- Electro®/2 Standard Bracket

#### The following models are not affected:

- Electro®/2 Extended Bracket
- No. 15 Mecho®/5 DoubleShade Bracket
- No. 17 Electro®/2 DoubleShade Bracket
- No. 21 Electro®/3 DoubleShade Bracket